

Technical data | eCoo 20 ST

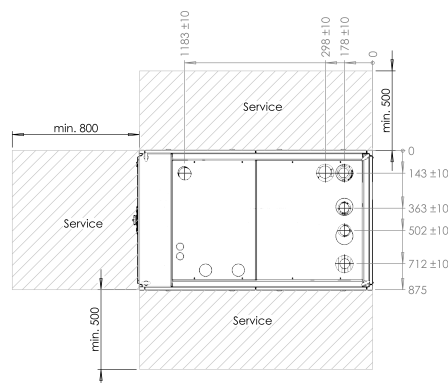
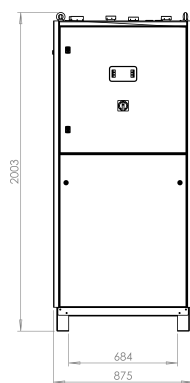

- * High efficiency pumps included in all three circuits
- * System separation integrated for direct connection to glycol recooling circuit
- * Integrated free cooling mode without additional hydraulic
- * SIEMENS controller in compliance with industry standard
- * Cloud based visualization and remote programming from anywhere available
- * Integrated communication services: BACnet IP, BACnet MS/TP, M-Bus, LON, Modbus RTU and OPC
- * Internal serial connection of the modules possible to optimize performance and temperature spread

MODEL

eCoo 20 ST

APPLICATION RANGE

Hot water temperature	50 - 95°C
Re-cooling water temperature	22 - 40°C
Chilled water temperature	8 - 21°C
Max. operating pressure	4 bar

DIMENSIONS

W x D x H	875 x 1,465 x 2,003 mm
Footprint	1.28 m ²
Empty weight	ca. 843 kg

ELECTR. POWER CONSUMPTION AND SUPPLY

At typical pressure drop	1,070 W
At max. delivery head	2,150 W
Power supply	230 V, 50/60 Hz

PERFORMANCE

Cooling capacity	up to 33.4 kW
COP _{TH}	up to 0.65

HOT WATER CIRCUIT

Volume flow rate	5.00 m ³ /h
Available delivery head	400 mbar
Connection	G 2" AG

RE-COOLING CIRCUIT

Volume flow rate	11.80 m ³ /h
Available delivery head	650 mbar
Connection	G 2 ½" AG

CHILLED WATER CIRCUIT

Volume flow rate	5.80 m ³ /h
Available delivery head	520 mbar
Connection	G 2" AG